

---

To: **Town Of Carleton Place**  
Ross Rankin, Property and Project Manager

Locations: 75 Neelin Drive, Carleton Place, ON - Carleton Place Arena  
351 Bridge Street, Carleton Place, ON - Carambeck Community Centre

---

Date: 2026-06-10

Reference: [100-2607] Carleton Place Arena & Carambeck Community Centre -  
Replace Rooftop Units

This Addendum forms part of the contract documents and is to be read, interpreted, and coordinated with all other parts. The cost of all contained herein is to be included in the contract sum. The following revisions supersede the information contained in the original drawings and specifications issued for the above-named project to the extent referenced and shall become part thereof. Acknowledge receipt of this Addendum by inserting its number and date on the Tender Form. Failure to do so may subject the Bidder to disqualification.

---

Clarifications/Modifications/Additions:

With reference to RFP Document 'PM-05-2025' (Original Revision):

1. Closing date for RFP response submission to be **2:00PM, local time, on June 11th, 2026.**

With reference to mechanical/electrical 'Issued for Tender' drawing set dated 2026-04-30:

2. For RTU-1, RTU-2, and RTU-3:
  - a. Contractor to supply new seismically-rated 24" downflow hybrid curb for installation by approved base building roofing contractor (Simluc). Contractor to carry base building roofing contractor for all roofing work.
  - b. Contractor to provide seismic sign-off letter for supplier/installed roof curb from seismic engineer licensed in the Province of Ontario.
  - c. The existing roofing is to be removed around existing curb an acceptable distance to complete new curb installation and all tie-in detailing. New 16mm plywood sheathing to be installed around perimeter of curb as noted. New vapour barrier overlapping to be completed as indicated. New roof components to be installed to match with all required detailing and overlapping. All works must be completed as per manufacturer (Soprema) requirements to maintain 15-year full system warranty. Soprema to be contacted prior to new curb installations to ensure warranty compliance
  - d. Refer to attached roofing detail.

1. COMPLETE ALL NEW MECHANICAL PENETRATION (I.E. CURBS, SLEEPERS & PIPE ENCLOSURES) TIE-INS AT VARIOUS ROOF AREAS. REFER TO PROJECT MECHANICAL & ELECTRICAL DRAWINGS FOR ALL LOCATIONS. REFER TO APPLICABLE ROOFING DETAIL.
2. THIS DETAIL INDICATES GENERAL TIE-IN REQUIREMENTS. REFER TO SPECIFIC ASSOCIATED ROOFING DETAIL FOR ALL TIE-IN REQUIREMENTS (I.E. THERMAL INSULATION, MEMBRANE LAYERS, COMPONENTS, ACCESSORIES, ETC.)
3. DEGRANULATE ALL EXISTING MEMBRANE SURFACES AS REQUIRED.

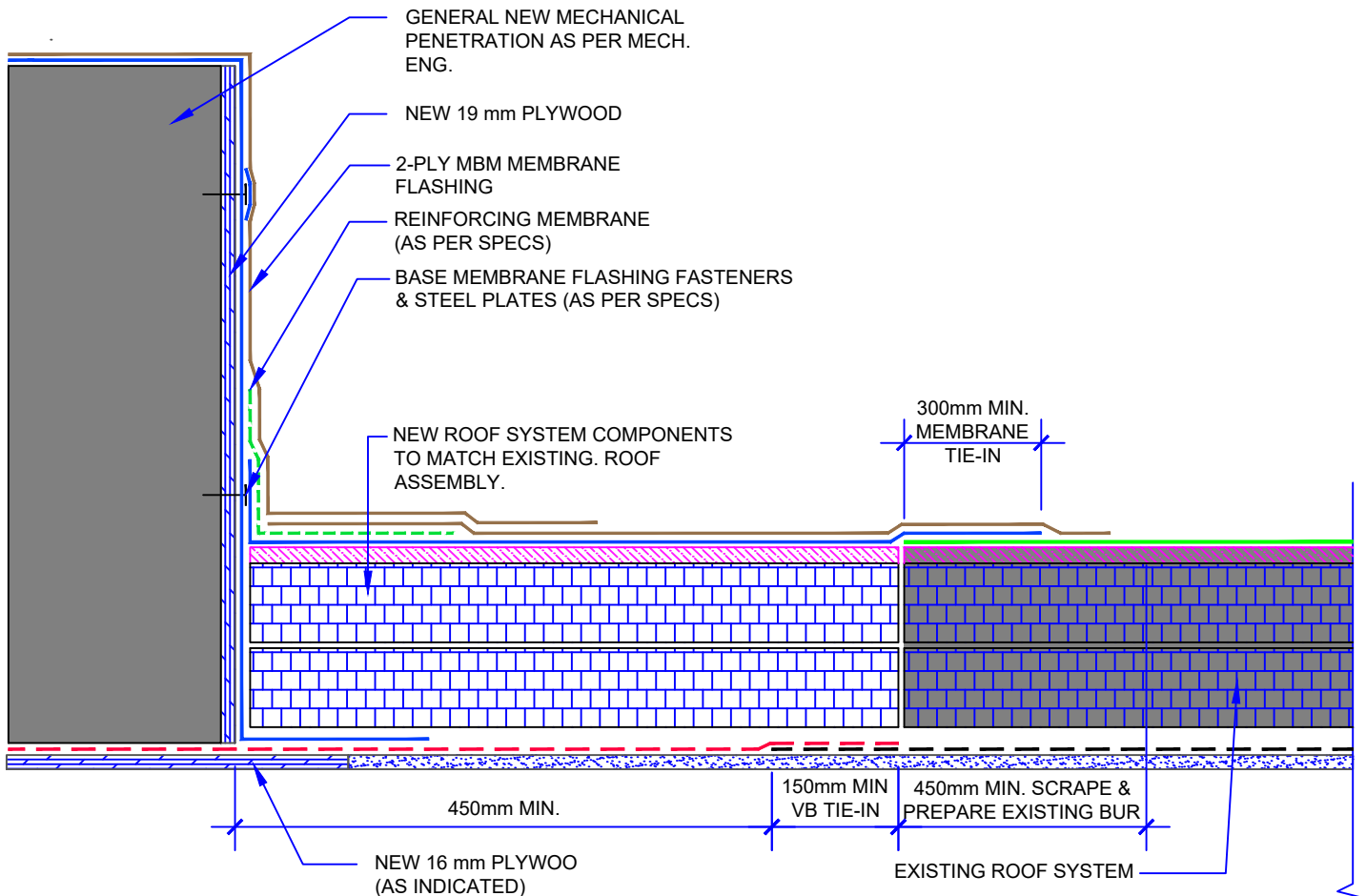

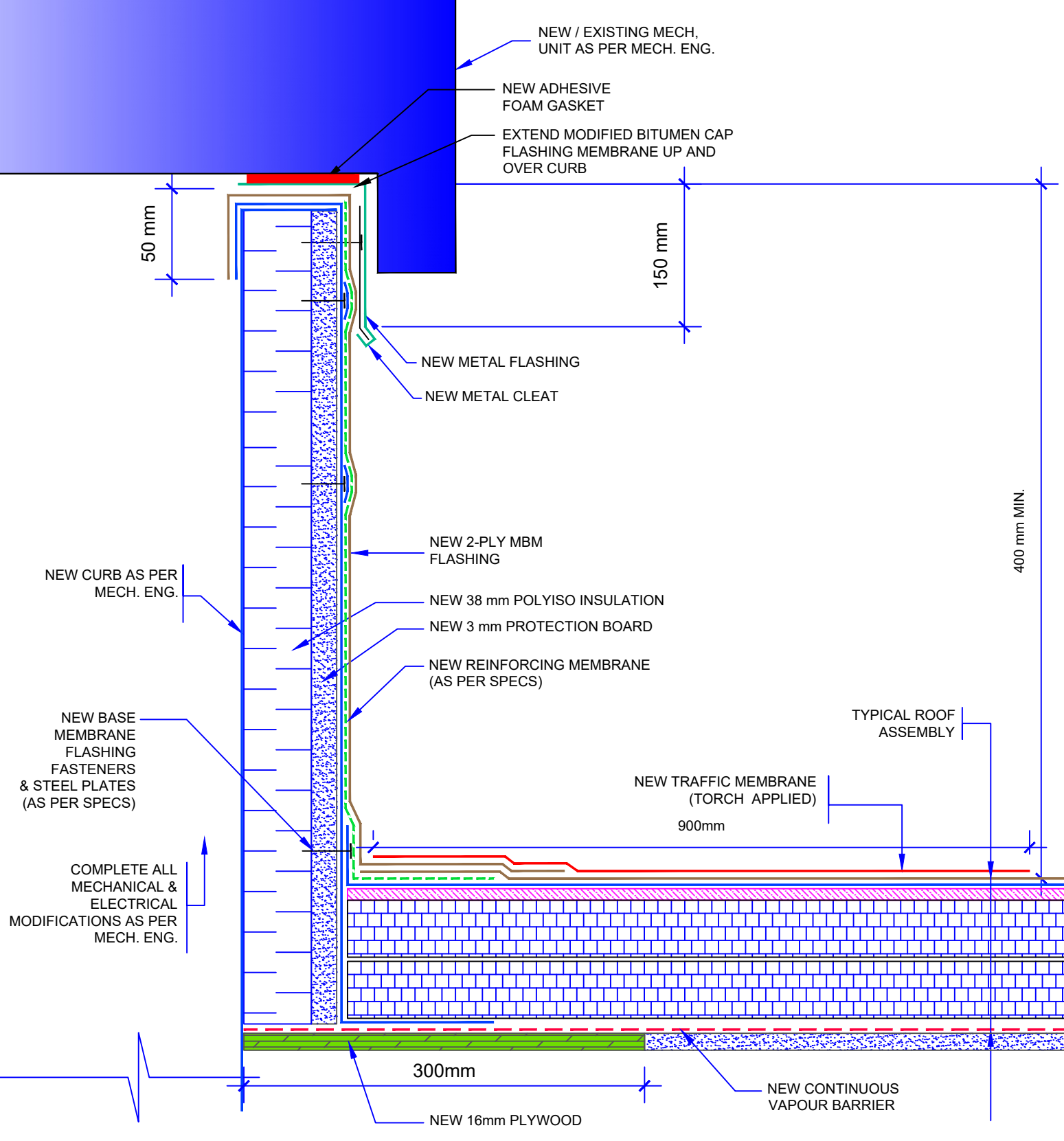

**END OF ADDENDUM**